

DDPR_feedback_0232s		
	Name	Mark, Jayne, Val and Tony Strachan
	Organisation	Vernazza Limited
	Email	██████████
	Response Date	Sep 9 22
	Notes	
Q1	Select the chapter you want to provide feedback on	
Q2	In general, to what extent do you support the contents of this chapter?	
Q3	Objective/Policy/Rule/Standard reference:	
Q4	Feedback/Comments	
Q5	Objective/Policy/Rule/Standard reference:	
Q6	Feedback/Comments	
Q7	Objective/Policy/Rule/Standard reference:	
Q8	Feedback/Comments	
Q9	Objective/Policy/Rule/Standard reference:	
Q10	Feedback/Comments	
Q11	supporting documents?	
	0	
Q12	If you need more space, or have any other general comments, please leave them here	

# **Table of Contents**

<b>Email .....</b>	<b>2</b>
<b>District planning .....</b>	<b>3</b>

**Mark Smith**

---

**Subject:** FW: District Plan Review Maps + Info

---



**External Email** Be careful with links and attachments. Think before clicking – do I know this person and does this person's request make sense?

Hi Caitlin,

Thanks for your time in sending us our maps, I have sent though a separate email with map with the areas that if possible could be removed from the significance to maori and returned to general rural zone as per the rest of the property. Hopefully the lines added make sense, we accept that the awamoko creek will need to remain in this zoning but the small areas to the north west of our property make no sense. If you need any clarification please let us know.

Kind Regards,

Mark, Jayne, Val and Tony Strachan

Mark and Jayne Strachan

Vernazza Limited



Part Lot 11 DEEDS '89  
Decisions for Planning Profiles & Have Your Say

5027056

1431182

# District Plan Mapping

Sites and Areas of Significance to Māori  
General Rural Zone

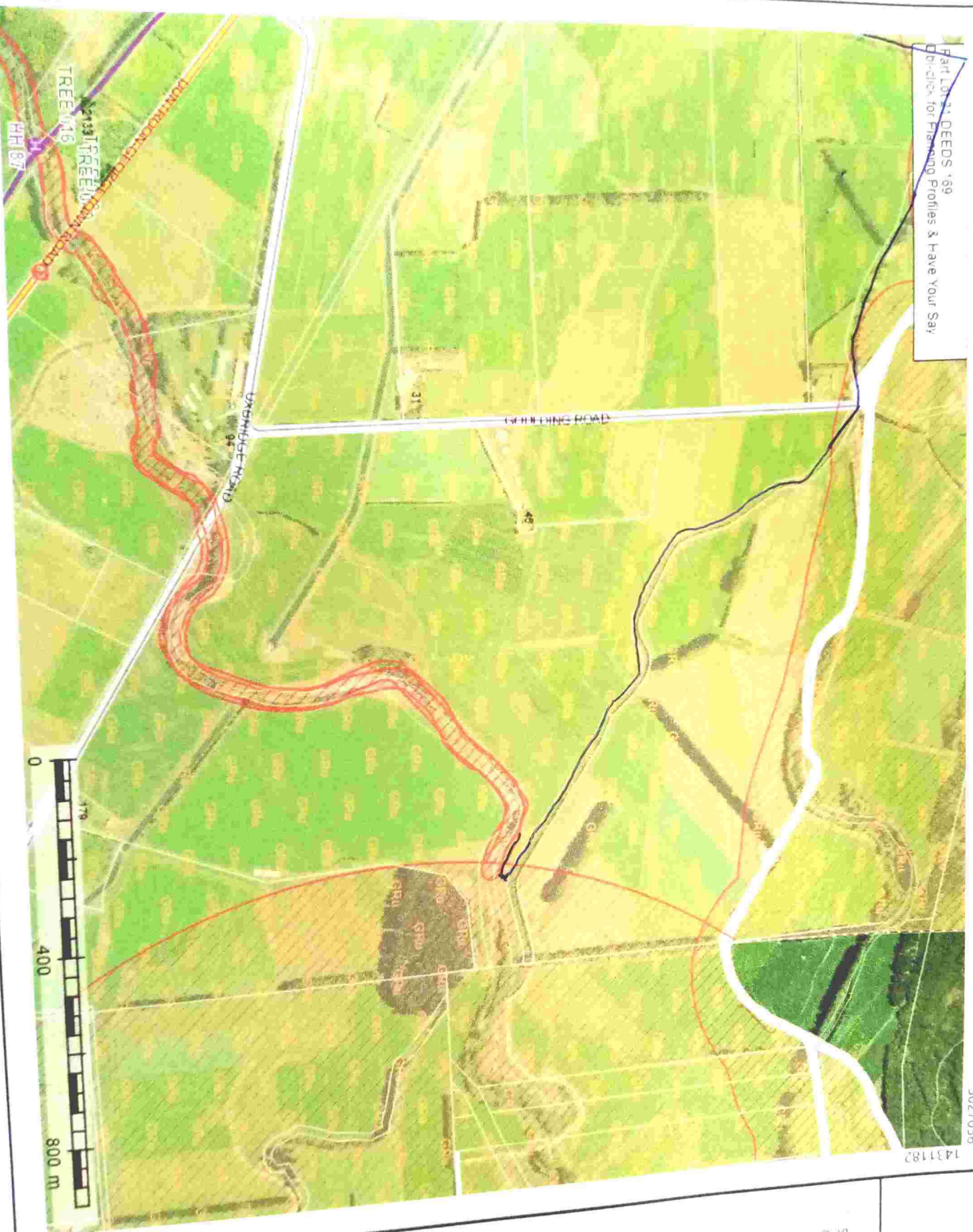

1428742