

DDPR_feedback_0033s	
Name	Chris Howes
Organisation	
Email	
Response Date	Aug 22 22
Notes	
Q1	Select the chapter you want to provide feedback on
Q2	In general, to what extent do you support the contents of this chapter?
Q3	Objective/Policy/Rule/Standard reference:
Q4	Feedback/Comments
	<p>From: Chris Howes Sent: Monday, 22 August 2022 10:28 AM To: Heather Bauchop Subject: Re: Existing pre-1900 Stone Barn located at 8 Stone St. Reidston, Waitaki District... [THIS EMAIL IS FROM AN EXTERNAL SOURCE] DO NOT CLICK links or attachments unless you recognise the sender email address and know the content is safe. [cid:CwhfYFQlhUIMWOkhnJ2z] Hi Heather, Thanks for getting back to me. Yes, the essence of my email is a request to nominate the Barn in Stone Street, Reidston for the district plan Heritage Schedule.</p> <p style="text-align: center;">So who is the person(s)</p> <p>that makes the call that it is or not for entry to the District Plan Heritage Schedule? Will certainly provide some feed back in the Council's District Plan review website.</p> <p>Cheers, Chris Howes On Monday, 22 August 2022 at 10:06:38 am NZST, Heather Bauchop wrote: Hi Chris, Thanks for your all your research and hard work. That's an interesting barn. You mention wanting to protect the barn from demolition. From a 'protection' point of view, Council's mechanism is a district plan listing. Is your email a request to nominate the barn for the district plan heritage schedule? You can also provide feedback through the Council's District Plan Review website:</p> <p>https://www.waitaki.govt.nz/Council/Consultation/district-plan-review [https://protect-au.mimecast.com/s/nXsRCD1vOwFwYGxCWBGFI?domain=waitaki.govt.nz].</p> <p>As you are aware, the archaeological provisions of the Heritage New Zealand Act apply to any pre-1900 site of human activity. I haven't been able to tell whether this building is a recorded site with the NZ Archaeological Association (the association's website is malfunctioning today). Best wishes, Heather</p> <p>Heather Bauchop Heritage Advisor Email: hbauchop@waitaki.govt.nz Web: www.waitaki.govt.nz</p> <p>Morning Heather, Located during more recent research of "Herbert Rd. Barn". Another barn is still standing in Stone Str. Reidston. Have gathered the key documents to easily establish this structure is pre-1900. Why has this not been notified or documented by the Waitaki District Council ? If you could please forward to the "experts" in Culture Waitaki archives for help and to try and save this structure before it is destroyed by some landowner, we should all be happy. William Rawson was the first landowner of the section this structure stands on... Thanks again. Cheers, Chris Howes (p.s the tidy images of barn taken 3 weeks ago.)</p>
Q5	Objective/Policy/Rule/Standard reference:
Q6	Feedback/Comments

Q7	Objective/Policy/Rule/Standard reference:
Q8	Feedback/Comments
Q9	Objective/Policy/Rule/Standard reference:
Q10	Feedback/Comments
Q11	supporting documents?
	0
Q12	If you need more space, or have any other general comments, please leave them here

Table of Contents

Existing pre-1900 Stone Barn located at 8 Stone St. Reidston, Waitaki District...	2
Maheno Taven Stone Street Herbert Weston Road 69 June 2022 008	4
Maheno Taven Stone Street Herbert Weston Road 69 June 2022 018	5
Maheno Taven Stone Street Herbert Weston Road 69 June 2022 029	6
Maheno Taven Stone Street Herbert Weston Road 69 June 2022 033	7
nInzimage (22).....	8
OT2C_932_Title_Historic_View	9
Stone Str. REIDSTON HISTORIC Owners of Stone Barn	11
Stone Street, Reidston.Stone Barn 001	12
Town of Reidston Block III.....	13

Mark Smith

From: Plan Review
Sent: Tuesday, 23 August 2022 4:19 PM
To: Mark Smith
Subject: FW: Existing pre-1900 Stone Barn located at 8 Stone St. Reidston, Waitaki District...
Attachments: Stone Street, Reidston.Stone Barn 001.jpg; Town of Reidston Block III.jpg; nlnzimage (22).jpg; Maheno Taven Stone Street Herbert Weston Road 69 June 2022 008.JPG; Maheno Taven Stone Street Herbert Weston Road 69 June 2022 018.JPG; Maheno Taven Stone Street Herbert Weston Road 69 June 2022 029.JPG; Maheno Taven Stone Street Herbert Weston Road 69 June 2022 033.JPG; Town of Reidston Block III.jpg; OT2C_932_Title_Historic_View.pdf; Stone Str. REIDSTON HISTORIC Owners of Stone Barn.jpg

Rachael Bason
Resource Management Planner – Policy

Email: rbason@waitaki.govt.nz
Web: www.waitaki.govt.nz
Tel: +64 3 433 0300

Waitaki District Council
20 Thames Street
Private Bag 50058
Oamaru
Waitaki District
Otago 9444
New Zealand



The information transmitted, including attachments, is intended only for the person(s) or entity to which it is addressed and may contain confidential and/or privileged material. Any review, retransmission, dissemination or other use of, or taking of any action in reliance upon this information by persons or entities other than the intended recipient is prohibited. If you received this in error please contact the sender and destroy any copies of this information.

From: Heather Bauchop <hbauchop@waitaki.govt.nz>
Sent: Monday, 22 August 2022 10:53 am
To: Plan Review <planreview@waitaki.govt.nz>
Subject: FW: Existing pre-1900 Stone Barn located at 8 Stone St. Reidston, Waitaki District...

fyi

Heather Bauchop
Heritage Advisor

Email: hbauchop@waitaki.govt.nz
Web: www.waitaki.govt.nz
Tel: +64 3 433 0300

Waitaki District Council
20 Thames Street
Private Bag 50058
Oamaru
Waitaki District
Otago 9444
New Zealand





WE LOVE THIS PLACE WAITAKI

The information transmitted, including attachments, is intended only for the person(s) or entity to which it is addressed and may contain confidential and/or privileged material. Any review, retransmission, dissemination or other use of, or taking of any action in reliance upon this information by persons or entities other than the intended recipient is prohibited. If you received this in error please contact the sender and destroy any copies of this information.

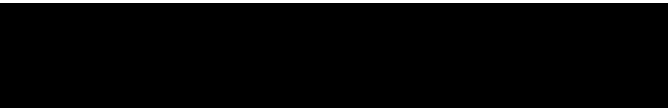

Subject: Existing pre-1900 Stone Barn located at 8 Stone St. Reidston, Waitaki District...



External Email Be careful with links and attachments. Think before clicking – do I know this person and does this person's request make sense?

Morning Heather, Located during more recent research of 'Herbert Rd. Barn".Another barn is still standing in Stone Str. Reidston. Have gathered the key documents to easily establish this structure is pre-1900. Why has this not been notified or documented by the Waitaki District Council ? If you could please forward to the "experts" in Culture Waitaki archives for help and to try and save this structure before it is destroyed by some landowner,we should all be happy.William Rawson was the first landowner of the section this structure stands on... Thanks again. Cheers, Chris Howes (p.s the tidy images of barn taken 3 weeks ago.)







1854
1854

1854
1854



Plan of the Town of REIDSTON.

E.R. Ussher, Surveyor, July, 1870.

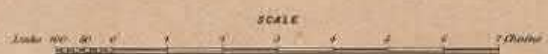
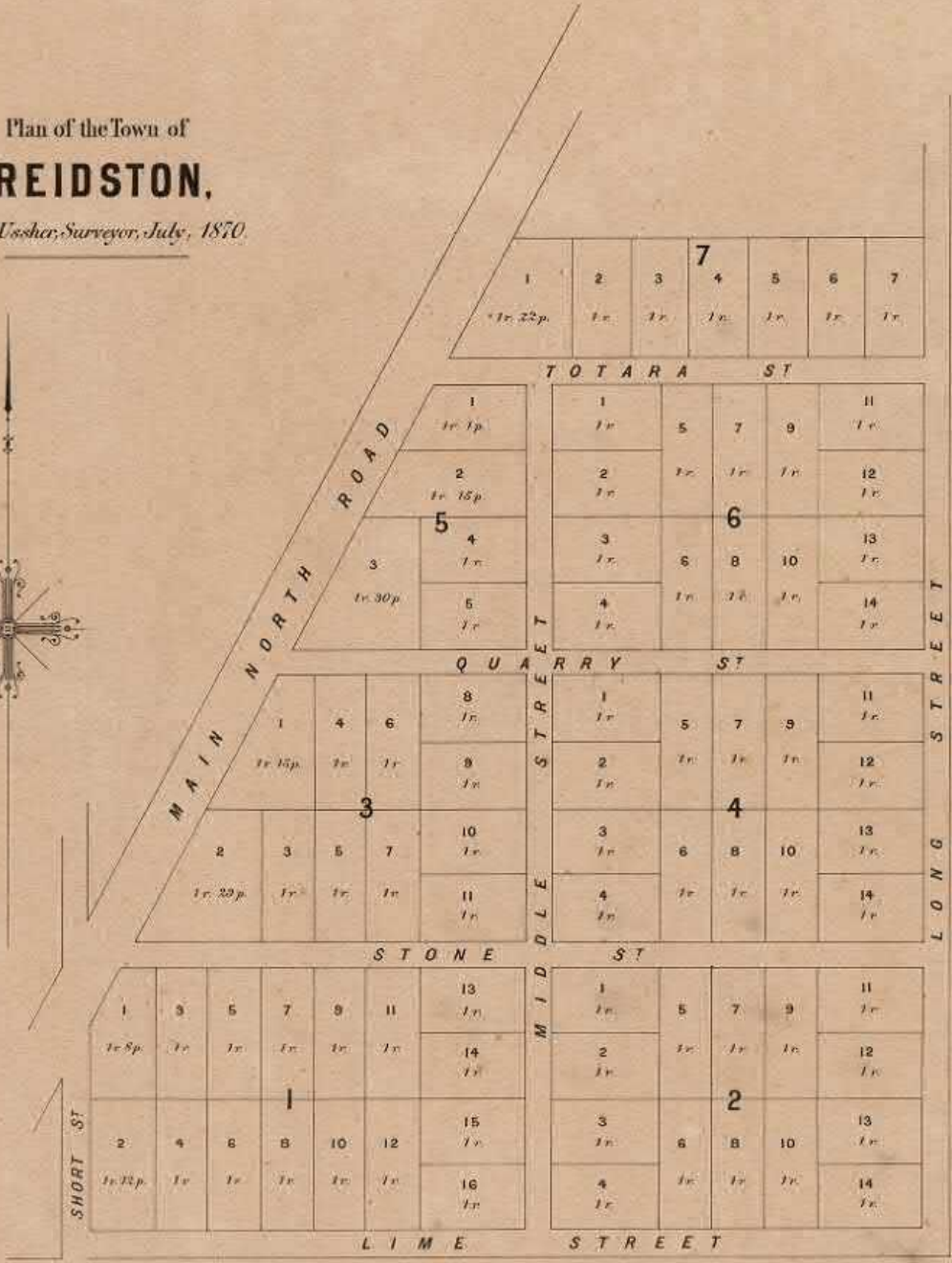

NOTE. A circular area 20 feet diameter over each Trig Station and right of way thereto is reserved by Government. A 50 penalty is incurred by persons removing or destroying Trig Stations or Survey Posts.



**RECORD OF TITLE
UNDER LAND TRANSFER ACT 2017
FREEHOLD
Historical Search Copy**



R.W. Muir
Registrar-General
of Land

Constituted as a Record of Title pursuant to Sections 7 and 12 of the Land Transfer Act 2017 - 12 November 2018

Identifier OT2C/932
Land Registration District Otago
Date Issued 23 February 1966

Prior References
OT2/182

Estate Fee Simple
Area 2023 square metres more or less
Legal Description Section 5 and Section 7 Block III Town of Reidston

Original Registered Owners
Ivan Charles Ericsson and Susan Isabel Ericsson

Interests

730659.2 Mortgage to Bank of New Zealand - 12.6.1989 at 9:59 am
962860.3 CERTIFICATE UNDER SECTION 37 BUILDING ACT 1991 (AFFECTS CT OT42/258) - 23.2.1999 AT 2.50 PM
8637152.1 Variation of Mortgage 730659.2 - 30.11.2010 at 10:49 am
11988275.1 Discharge of Mortgage 730659.2 - 28.1.2021 at 3:37 pm
11988275.2 Transfer to Roger Putt and Marilyn Elizabeth Rusher - 28.1.2021 at 3:37 pm

References

Prior D/T, 2/182

Land and Deeds 69

No. 2C/932

Transfer No. 224954
N/C. Order No. 296885



REGISTER

CERTIFICATE OF TITLE UNDER LAND TRANSFER ACT

This Certificate dated the 23rd day of February one thousand nine hundred and sixtysix under the seal of the District Land Registrar of the Land Registration District of O T A G O

WITNESSETH that GORDON WALTER CLOUGH of Rangiora, Shearer, and CHRISTINA PEARL CLOUGH his wife as tenants in common in equal shares are

disposed of an estate in fee-simple (subject to such reservations, restrictions, encumbrances, liens, and interests as are notified by memorial underwritten or endorsed hereon) in the land hereinafter described, delineated with bold black lines on the plan hereon, be the several admeasurements a little more or less, that is to say: All that parcel of land containing 2 roods more or less being Sections 5 and 7, Block III TOWN OF REIDSTOWN.

551618 Transmission to Christina Pearl Clough of Reidston Widow as executrix entered 26.3.1981 at 2.04 pm

[Signature]
A.L.R.



730659/1 Transfer to Ivan Charles Ericsson of Reidston, Senior Service Operator and Susan Isabel Ericsson of Reidston, Potter - 12.6.1989 at 9.59am

[Signature]
A.L.R.

730659/2 Mortgage to Bank of New Zealand - 12.6.1989 at 9.59am

[Signature]
A.L.R.

962860.3 Certificate under Section 37 of Building Act 1991 (affects CT 42/258) 23.2.1999 at 2.50

[Signature]
for RGL

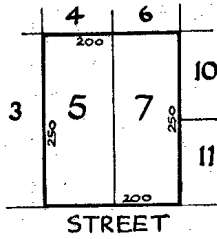

EQUIVALENT METRIC AREA IS ... 2023 m²

Scale: 1 inch = 2 chains
Total Area : 0. 2. 00.



L. 000/1/81-80879 W

Register copy for L. & D. 69, 71, 72

No. 2C/932

7/3/22, 9:53 PM

Google Earth

← 5 Stone St Reidston, Otago

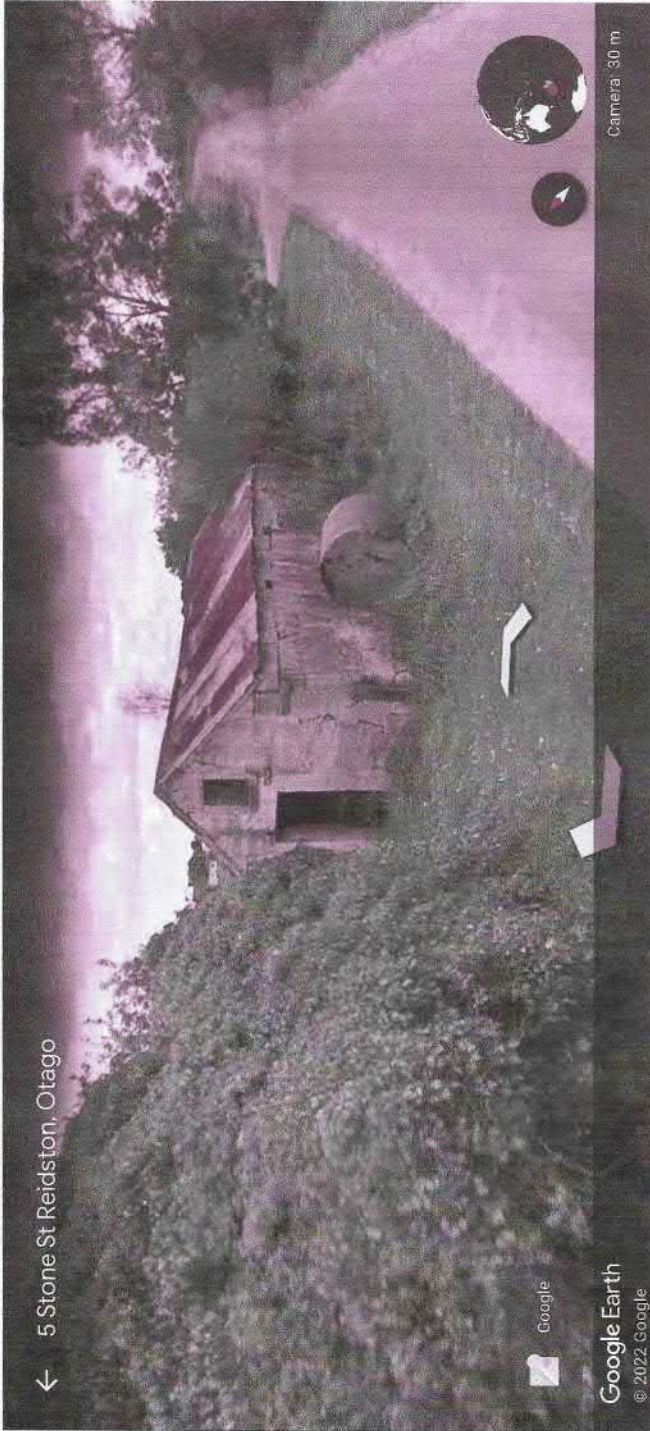

Google

Google Earth

© 2022 Google



Camera 30 m

ALLOTMENT. No.	Block	DATE OF AUCTION.	PURCHASER.	DATE OF PAYMENT.	AMOUNT. PAID.	Crown Grant.		REMARKS.
						Reg.	No.	
12	2	21 Decr. 74	George Mathews	6 Jan'y 75	4 ..	20/85	19142	
13		1 Decr. 71	George Mathews	2 Decr. 71	7 10 ..	17/12/85	10285	
14		1 Decr. 71	George Mathews	2 Decr. 71	7 10 ..	"	"	
Use Crown Lands Register								
1	3	13 Oct. 70	Robert West	3 Nov. 70	5 ..	20/87	12634	
2		13 Oct. 70	John Wilson	26 Oct. 70	5 ..	"	12819	
3		27 July 74	Joseph McEwan	6 Aug. 74	5 ..	20/80	18025	
4		13 Oct. 70	Robert West	3 Nov. 70	3 ..	20/87	12634	
5		11 Jan'y 71	William Rawson	9 Feb'y 71	3 ..	20/88	12978	
6		21 Decr. 74	James Wheatley	20 Feb'y 75	4 ..	20/86	19144	
		4 Jan'y 71	William Rawson	9 Feb'y 71	3 ..	20/88	12978	
7		11 Jan'y 71	William Rawson	9 Feb'y 71	3 ..	20/88	12978	
8		27 July 74	John McFarlane	8 Sept. 74	4 ..	20/85	19145	
9		27 July 74	John McFarlane	8 Sept. 74	3 3 ..	do	do	
10		27 July 74	William Rawson	31 Aug. 74	6 ..	20/85	19144	
11		27 July 74	William Rawson	31 Aug. 74	5 ..	do	do	
Use Crown Lands Register								
1	4	27 July 74	James Bee	8 Sept. 74	5 5	20/84	19087	
2		27 July 74	James Bee	8 Sept. 74	4 ..	20/79	18017	
3		27 July 74	James Bee	8 Sept. 74	5 ..	"	"	
4		27 July 74	James Bee	8 Sept. 74	4 ..	20/84	19087	
5		27 July 74	James Bee	8 Sept. 74	3 10 ..	"	"	
6		27 July 74	James Bee	8 Sept. 74	4 10 ..	"	"	
7		27 July 74	Thomas Curran	20 Aug. 74	3 ..	20/85	19145	
8		27 July 74	John Halkett	7 Aug. 74	3 ..	20/80	18023	
9		27 July 74	Bridget Curran	20 Aug. 74	4 ..	20/85	19146	
10		27 July 74	John Halkett	7 Aug. 74	3 ..	20/80	18023	
11		21 Decr. 71	Thomas Curran	19 Jan'y 75	4 ..	20/85	19258	
12		27 July 74	James Wheatley	6 Aug. 74	3 10 ..	20/80	18024	
13		27 July 74	James Wheatley	6 Aug. 74	3 15 ..	"	"	

297

DDPR_feedback_0323s		
	Name	Christopher Howes
	Organisation	
	Email	
	Response Date	Aug 22 22 10:44:40 am
	Notes	CptPL
Q1	Select the chapter you want to provide feedback on	
	Historic Heritage	
Q2	In general, to what extent do you support the contents of this chapter?	
	Agree	
Q3	Objective/Policy/Rule/Standard reference:	
Q4	Feedback/Comments	
	More positive Identification of structures to the past areas.. Villages, fences, boundary lines, creek crossings	
Q5	Objective/Policy/Rule/Standard reference:	
Q6	Feedback/Comments	
Q7	Objective/Policy/Rule/Standard reference:	
Q8	Feedback/Comments	
Q9	Objective/Policy/Rule/Standard reference:	
Q10	Feedback/Comments	
Q11	supporting documents?	
	0	
Q12	If you need more space, or have any other general comments, please leave them here	

Rachael Bason

From: [REDACTED]
Sent: Thursday, 30 June 2022 4:39 pm
To: Rachael Bason
Subject: Request: Nomination of a long line of Cupressus arizonica 'Blue Ice' Trees for inclusion in the District Plan as "Notable Trees"
Attachments: Topo of tree line on HW 83 Omarama 2022 001.jpg; Linz Boundaries 2022 001.jpg; Landowners of Notable Trees 2022 001.jpg; Blue Ice.... Cupressus arizonica 001.jpg; Retro Lens 1960 001.jpg; NZTR Stem Threshold Scores !!! 001.jpg; HW 83 Omarama. Avenue of Notable Trees 2022 012.JPG; HW 83 Omarama. Avenue of Notable Trees 2022 001.JPG; HW 83 Omarama. Avenue of Notable Trees 2022 002.JPG; HW 83 Omarama. Avenue of Notable Trees 2022 009.JPG; HW 83 Omarama. Avenue of Notable Trees 2022 019.JPG



External Email Be careful with links and attachments. Think before clicking – do I know this person and does this person's request make sense?

Hi Rachael, Attended the WDC 'drop-in' at Omarama this morning and the crew' informed me that I was to email you the request for this 1.1 Km long line Cupressus arizonica trees, which are all along the road boundary fence of the 8 properties, for nomination. Attachments will show the title numbers and owners names. Most were planted in 1998 and then the others in early 2001. 99% of them have reached their mature height . They provide an excellent Alpine visual appearance along this busy entrance and exit on HW 83. Also they run parallel to the A2O cycleway. They are really ideally suited to Omarama's tough climate and as you can see have been a success. So I do hope they can be assessed by your arborist and they pass the STEM values for District Plan inclusion.

Kind regards, Chris Howes



Buy Plants Online / Conifers / Cupressus arizonica 'Blue Ice'

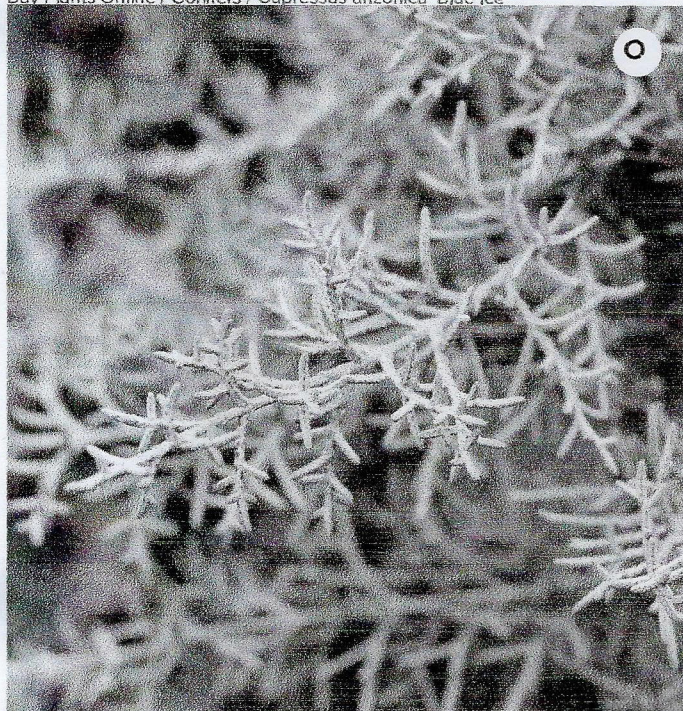

Cupressus arizonica 'Blue Ice'

Blue Arizona Cypress

Cupressus arizonica var. *glabra* 'Blue Ice' is a compact, conical selection of Arizona cypress with exceptionally attractive, frosty, silver-Blue foliage. This stunning tree adds contrast in colour, texture and that familiar Christmas tree form to the garden.

This cultivar is Kiwi bred, originating as a seedling selected in 1960 by Duncan & Davies Nursery, New Plymouth, who subsequently introduced it to the nursery trade in 1984.

'Blue Ice' will become a substantial tree over time. It is extremely tolerant of hot sun, drought and exposure making it a good choice for a low maintenance garden.



Growth Rate: **Medium**
Height after 5 years: **3m**
Height when mature: **5m**

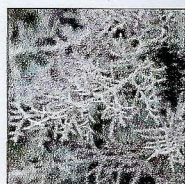

Buy Online - Pot Size

7cm Pot

50-65cm
2.5L Pot

14L Pot

Price **\$5.50** Each NZ\$ (inc GST)

Bulk Pricing 10 or more **\$4.65** 100 or more **\$4.20**

Sold Out

Quantity

Quantity input field with value 1 and a plus sign button

ADD TO CART

How does shipping work?

Our website will automatically calculate freight for smaller consignments. For bulkier orders, we'll be back in touch to confirm a freight price. Check out our Shipping Information page for more info.

Need more info?

Check out our FAQs, or Contact Us – we're here to help.

Our plant growth, height and grade information is given in good faith, but is subject to natural variables beyond our control.



Drainage
Dry / Moist



Sunlight
Full Sun / Partial
Shade



Origin
Exotic



Winter Foliage
Evergreen

Foliage Colour













Land Owners:

Title
No's Bryan James Patterson
1615 Michele Anne Patterson
Tracy Julia Trainor

190955 Angela Kaye Buchan
Wayne Buchan

190966 Andrew R.R. Heard
Sara Jean Heard.

190965 Georgina M. Robertson
Timothy P. Robertson

190964 Nicola F.M. McKercher
Richard T. McKercher

190963 Julie A. Familton
Tony B. Familton

190962 Gregory J. Stuart
Mary A. E. Stuart

130798 Christopher T. Howes

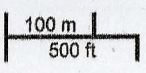
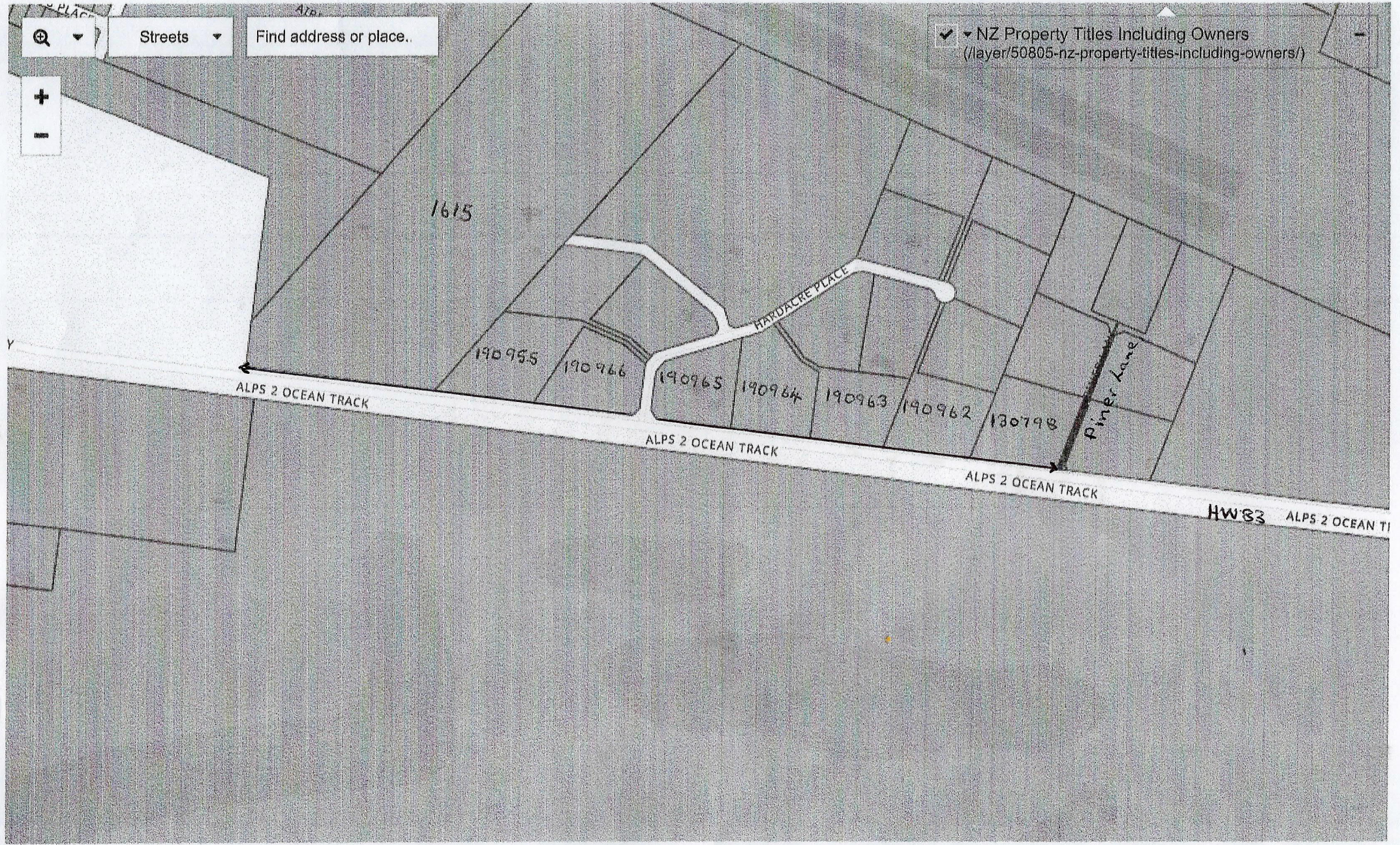



The New Zealand Tree Register

Supported by the New Zealand Arboricultural Association and the Royal New Zealand Institute of Horticulture

- Home
- About
- Purpose
- Measuring/Recording Trees
- Adding Trees
- Tree Register
- STEM™
- Contact
- Sponsors
- Donate
- Image Gallery
- Links

Current STEM Users [STEM Threshold Scores](#)

STEM Threshold Scores

The following table records a range of STEM™ threshold scores employed by users of the evaluation method. There is no set national threshold promoted by the NZNTT as this is left to each Local Authority to determine what trees are significant in their specific local context. Regional differences in the quality and notable attributes of tree stock around the country will also vary, therefore a significant tree in Waitaki is likely to score different to a significant tree in Waikato.

An important note: Direct comparison of STEM™ scores between Local Authorities presents challenges due to several factors. The regional differences in tree stock noted above. The inherent nature of evaluation methods introduces the potential for variation among assessors. There have also been some Councils that have adapted STEM by adding criteria which will result in inflated scores. Therefore direct comparisons are not advised.

Carterton	150 points
Dunedin	145 points
Far North	Under review
Gisborne	Unknown
Gore	Under review
Hastings	160 points OR a minimum of 50 years old AND including a notable attribute
Hauraki	87 points
Horowhenua	150 points
Kaipara	150 under review
Kapiti	140 points
Lower Hutt	120 points
Manawatu	150 points
Marlborough	150 points OR a tree with a local notable attribute
Masterton	None established
Matamata-Piako District	140 points
Napier	180 points
Nelson	100 points
Otorohaunga	160 points
Palmerston North	160 points (adapted STEM)
Porirua	120 points
Queenstown-Lakes	120 points
Rangitikei	Unknown
Rotorua Lakes	140 points
Selwyn	Unknown
South Taranaki	130 points for native trees 150 points for exotics
South Wairarapa	110 points proposed
South Waikato	Unknown
Tasman	120-149 points - Cat C, 150-190 points - Cat B, 190+ points - Cat A.
Taupo	110 points
Tauranga	130 points
Thames-Coromandel	170 points
Timaru	125 points proposed
Upper Hutt	100 points
Waikato	160 points
Waimakariri	90 under review
Waipa	110 points
Waitaki	100-150 points Cat B. 150+ Cat A - Under review
Wellington	110 points - under review
Western Bay of Plenty	120 points
Whakatane	135 points

NEWS

- 27th Oct 2020
2020 NZ Arb Annual Conference
- 11th May 2020
WINNER - NZTR Lockdown Quiz
- 4th May 2020
ANSWERS to NZTR Lockdown Quiz #4 - Historic & Notable
- 30th Apr 2020
NZTR Lockdown QUIZ #4 - Historic & Notable
- 23rd Apr 2020
ANSWERS to NZTR Lockdown Quiz #3 - Our Indigenous Wonders
- 16th Apr 2020
NZTR Lockdown QUIZ #3 - Our Indigenous Wonders
- 15th Apr 2020
ANSWERS to NZTR Lockdown Quiz #2 - General Knowledge
- 10th Apr 2020
NZTR Lockdown Quiz #2 - General Knowledge

SUBSCRIBE

Sign up to receive updates from Notable Trees.

Your details are safe with us and will not be shared in any way.

First Name:

Last Name:

Email Address:

[Privacy Policy](#)

Updated: 25 Feb. 2020

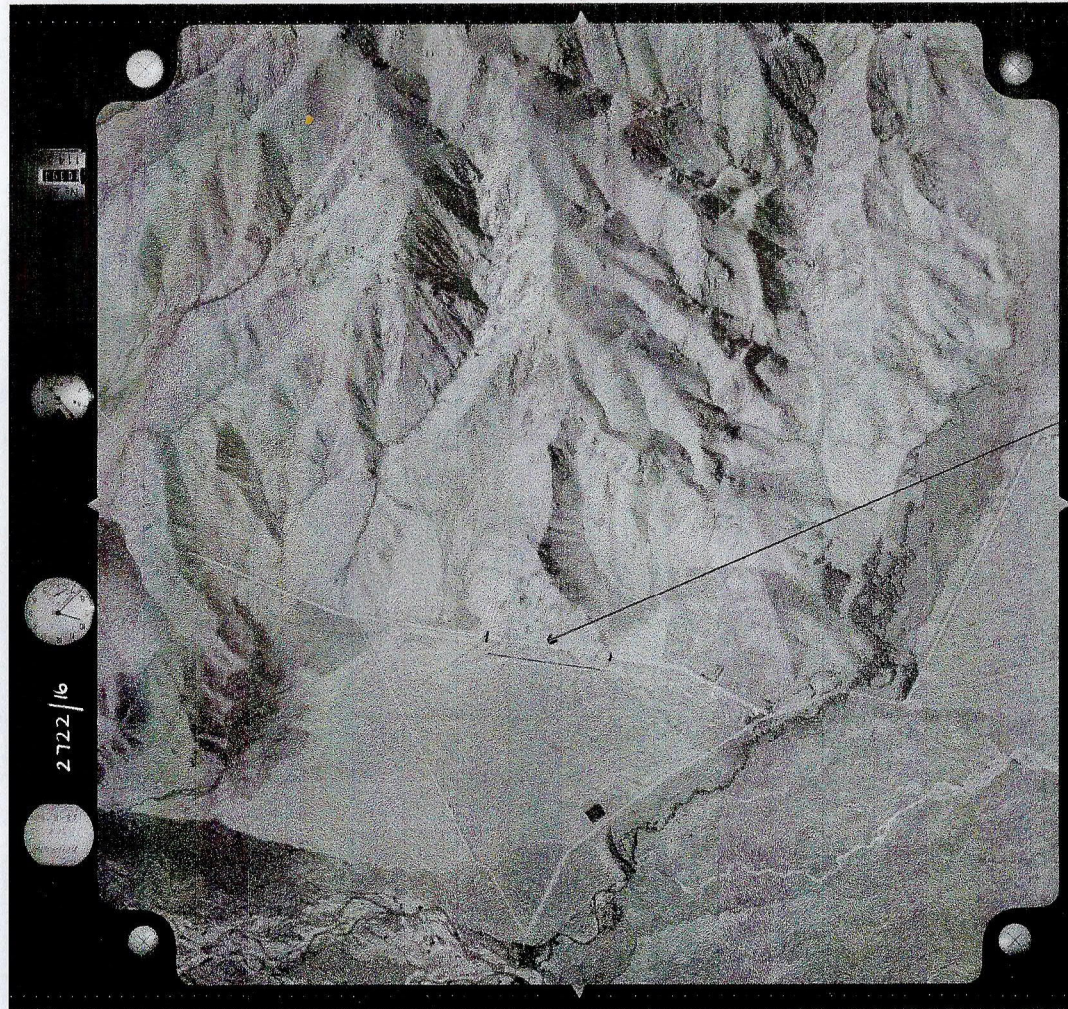

'Group' of "Blue Ice Arizona Cypress"

* Living North Side
of HW 83.

Omarama.

* All located on
Private Land.

* 1960 Aero Retro-
lens.

* Totally Decid
of Trees. !!

